

LOW INSERTION FORCE

REF. 11506

- Au – 1.5 N max (5.5 oz)
- Sn – 3 N max (11 oz)

Number of mating cycles – 500
Number of mating cycles – 50

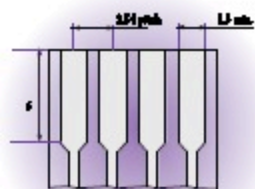

Contact lay out

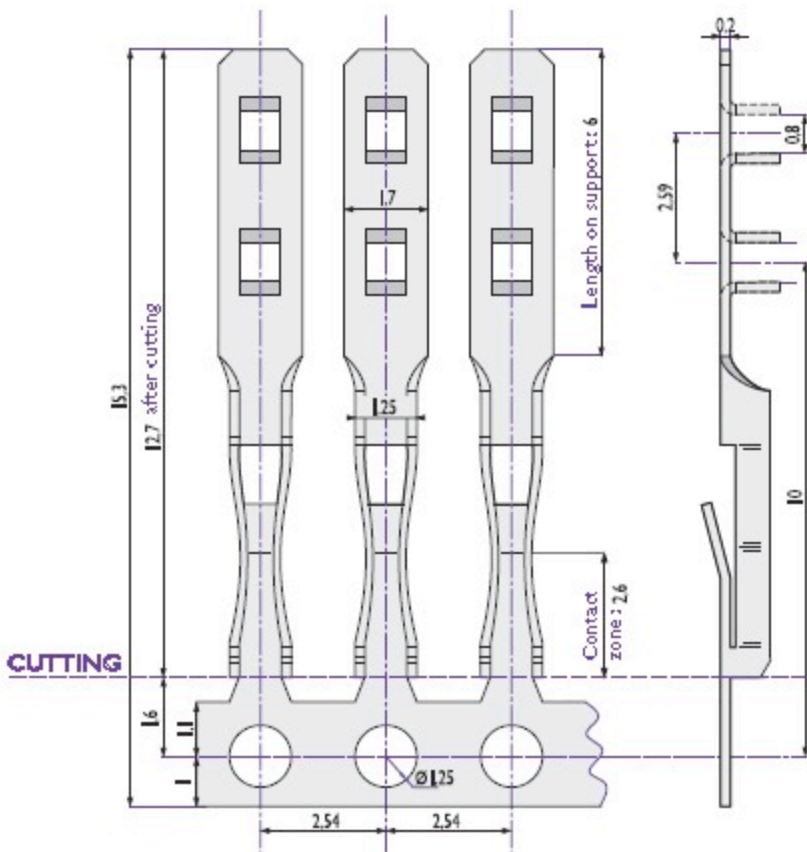

REF.	PLATING	REEL
11506-12	Tin plated	35 000 contacts
11506-32	Selective gold plated	35 000 contacts

OTHER PLATINGS - ON REQUEST

Dimensions in mm