

HF : high frequency contacts (series 30)

PRESENTATION

Male									
	Type D				Type E				
Female									
	Straight PCB	90° PCB	Straight SMT	90° SMT Card edge	Straight Crimp	90° Crimp	Straight solder	90° solder	

INFORMATION TABLE

CMM RANGE		TYPICAL USE										
		TYPE OF CONTACTS TO BE USED IN THE CMM CONNECTOR WITH CAVITIES FOR HF/HP CONTACTS ONLY										
		TYPE D FOR SPECIAL CONTACTS ON PCB (Eg.221D00F22-00 nbr of special contact-1300CMM)					TYPE E FOR SPECIAL CONTACTS ON CABLE					
		Straight on PCB		90° on PCB		Straight SMT	90° SMT Card edge	Straight Crimp	90° Crimp	Straight solder	90° solder	
100/200	Male											
	Female											
220	Male	30-1300-CMM L=3,0	30-1300-45 L=4,5	30-1400-CMM L=3,0	30-1400-45 L=4,5		30-1500-CMM without LF contact	30-1500-12	30-13XX-SS 30-13XX-DS xx=cable type	30-14XX-ZS 30-14XX-DS xx=cable type	30-13XX-ZZ xx=cable type	30-14XX-ZZ xx=cable type
	Female	30-2300-CMM L=3,0	30-2300-45 L=4,5	30-2400-CMM L=3,0	30-2400-45 L=4,5				30-23XX-SS 30-23XX-DS xx=cable type	30-24XX-ZS 30-24XX-DS xx=cable type	30-23XX-ZZ xx=cable type	30-24XX-ZZ xx=cable type
320	Male	30-1300-CMM L=3,0	30-1300-45 L=4,5	30-1400-CMM L=3,0	30-1400-45 L=4,5			30-1500-12	30-13XX-SS 30-13XX-DS xx=cable type	30-14XX-ZS 30-14XX-DS xx=cable type	30-13XX-ZZ xx=cable type	30-14XX-ZZ xx=cable type
	Female	30-2300-12 L=3,0	30-2300-14 L=4,5	30-2400-CMM L=3,0	30-2400-45 L=4,5				30-23XX-SS 30-23XX-DS xx=cable type	30-24XX-ZS 30-24XX-DS xx=cable type	30-23XX-ZZ xx=cable type	30-24XX-ZZ xx=cable type
340	Male											
	Female											

Standard contact
Any other type of contact upon request only

XX = 12, 20, 24, 26
Eg. 24 = cable Ø 2,4
XX = 20 or 26 for DS cable

XX = 47, 85
Eg. 47 for UT47 cable

Straight on PCB

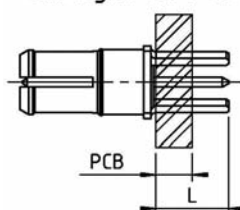

90° on PCB

