

CMM Harness

CMM pre-wired, part numbering

| | | | | | | | | | | | | | | | | | | | | | | | |
|---|---|---|---|---|---|-----|---|---|---|-----|---|---|----|----|---|---|---|---|---|---|---|---|---|
| H | C | x | x | G | W | (#) | P | n | n | (n) | F | - | yy | zz | - | A | # | B | D | L | L | L | L |
|---|---|---|---|---|---|-----|---|---|---|-----|---|---|----|----|---|---|---|---|---|---|---|---|---|

| HCxx | G | W | (#) | P | nn(n) | F | - | yyzz- | A | # | B | D | LLLL |
|---------------------------------|-------------|-------------|-------------------------|-------------------------------------|--|---|---|--|--|----------------------|--------------------------|--|---|
| CMM Series rows | Gender | Signal wire | Color wires | Integrated shape & potting | LF contact number | Fixing | | HP / HF Contact number | HP / HF wire | Color | Accessories | Harness configuration | Harness length |
| HC10 1 row (Only LF) | 1 Male | E | No signal (LF) contacts | Z No potting | 02 to 25 1 row (only LF) | Please refer to your selected CMM serie hardware paragraph of the CMM catalogue | - | If no HP/HF : Ø | | # See color table | Z No accessory | F Fly lead | LLLL <100 Tolerance ± 5 |
| HC20 2 rows (Only LF) | | H | AWG28 | | 04 to 50 2 rows (only LF) | | | L AWG20 M AWG18 N AWG16 O AWG14 P AWG12 A RG174 B RG178 D RG179 F RG316 | 100≤LLLL<0300 Tolerance ± 5 | | | | |
| HC22 2 rows | 2 Female | I | AWG26 | 04 to 60 2 rows | Number of HP (High Power) / HF (High Frequency) by side yy : first zz : last | | | Ø | B Back to back (only LF) | | | 0300≤LLLL<1500 Tolerance ± 10 | |
| HC32 3 rows | | J | AWG24 | 006 to 120 3 rows | | | | | | | | R Back to back reversed | 1500≤LLLL≤3000 Tolerance ± 50 |
| HC34 3 compact rows | | K | AWG22 | 006 to 120 3 compact rows | | | | | | | | | 3000<LLLL Tolerance ± 50 |

Please contact us for these options

Example of codification :
HC101H6Z10L-ZF0500

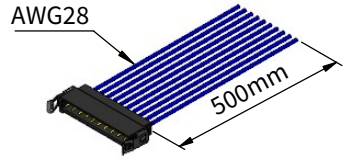

Example of codification :
HC321K8Z022F45-0302-06ZF0100

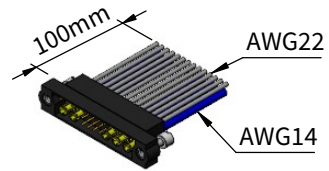

Example of codification :
HC221IRZ20F22-ZB0600

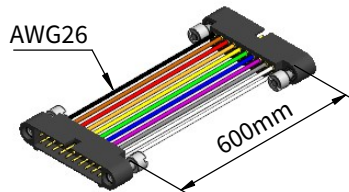

Z
(CMM 100 / 200 / 220)

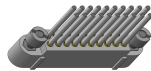

(CMM 320 / 340)

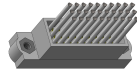

Q

(CMM 220)



(CMM 320 / 340)

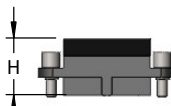
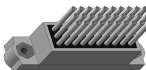

| # | Color |
|---|------------|
| Ø | No contact |
| 0 | Black |
| 1 | Brown |
| 2 | Red |
| 3 | Orange |
| 4 | Yellow |
| 5 | Green |
| 6 | Blue |
| 7 | Purple |
| 8 | Grey |
| 9 | White |

| Rainbow repeated | |
|------------------|--|
| R | Color order |
| Color order | Black Brown Red Orange Yellow Green Blue Purple Grey White |
| Contact number | 1 2 3 4 5 6 7 8 9 10 11 12 13 14 15 16 18 17 19 ... |

Male

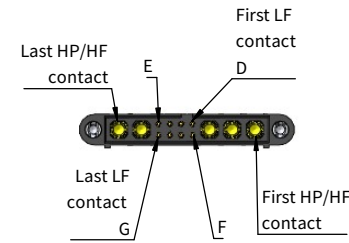

Female

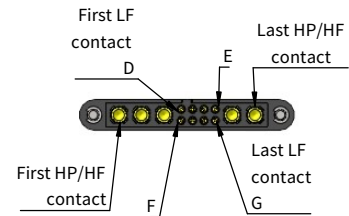

F

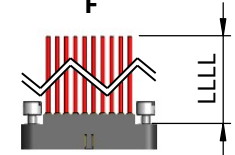

B

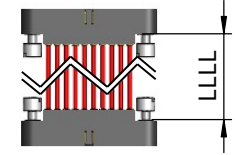

R

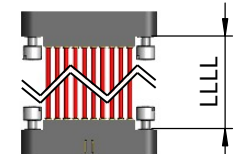

See cabling details on page 2



www.nicomatic.com

| | | | | |
|--------------------|----------|-------|---------|----------|
| 1 | 23/02/21 | P.B. | J.D. | C.F. |
| Iss | Date | Drawn | Checked | Approved |
| Item : CMM Harness | | | | |

This document is the property of Nicomatic. It may not be reproduced without the prior written permission of the owner. Law of 11 March 1902.

Catalogue Reference : HCxxGW(#Pnn(n)F-yyzz-A#BDLLLL

Compliant matrix : -
Customer reference : -



General tolerance ±0.2

Page 1/2

D

C

B

A

4

3

2

1

4

3

2

1

| Part number mixed layout | |
|--------------------------|---|
| nn(n): | Contacts LF number |
| yy: | Special contacts number (side LF pin 1) |
| zz: | Special contacts number (opposite side) |
| M: | Male |
| F: | Female |

One HP / HF
= four LF

| Length in mm | | | | | |
|--------------|------------|--|--------------|------------------|-------------------------------|
| | Type | B | C | D | Backpotting height (H ± 1 mm) |
| CMM 100 | Only LF | | (nn x 2)+3.4 | 3.5 | |
| CMM 200 | Only LF | | nn + 3.4 | 5.5 | M : H = 10.6 F : H = 10.1 |
| CMM 220 | Only LF | nn + 5 | nn + 10 | | M : H = 11.2 F : H = 10.7 |
| | Mixed | {(yy + zz) × 4} + nn + 5 | B + 5 | | M : H = 14.1 F : H = 13.7 |
| CMM 320 | Only HP/HF | {(zz × 4) + 5} | B + 5 | M : 7.7 F : 8 | M : H = 11.2 F : H = 10.55 |
| | Only LF | $\left\lceil \frac{nnn \times 2}{3} \right\rceil + 7$ | B + 6 | | |
| | Mixed | $\left\lceil \frac{\{(yy + zz) \times 4 + nnn\} \times 2}{3} \right\rceil + 7$ | B + 6 | | |
| CMM 340 | Only HP/HF | {(zz × 4) + 7} | B + 6 | M : 7.7 F : 8 | M : H = 11.2 F : H = 10.55 |
| | Only LF | $2.5 \times \left(\frac{yy + zz}{2} \right) + 7.5 + \left\lceil \frac{2 \times nnn}{3} \right\rceil$ | B + 6 | | |
| | Mixed | $2.5 \times \left(\frac{yy \text{ or } zz}{2} \right) + 7.25 + \left\lceil \frac{2 \times nnn}{3} \right\rceil$ | B + 6 | | |
| | Only HP/HF | $\left\lceil \frac{zz \times 2.5}{2} \right\rceil + 7.5$ | B + 6 | | |

For other dimensions, CMM 3D and drawings can be downloaded on our website : www.nicomatic.com

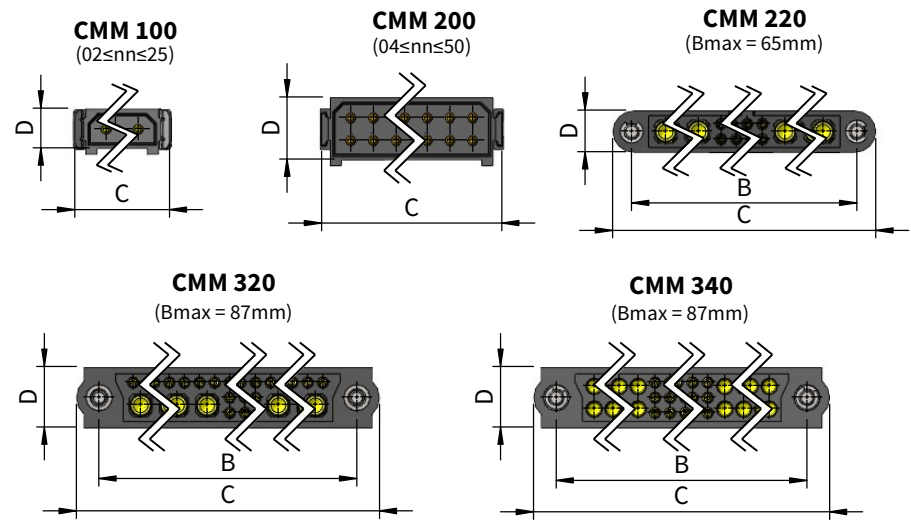

B
Back to back
(Only LF)

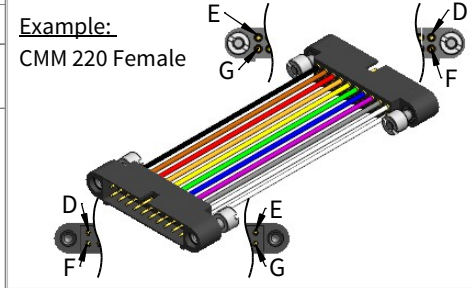
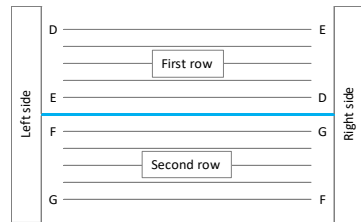

R
Back to back reversed

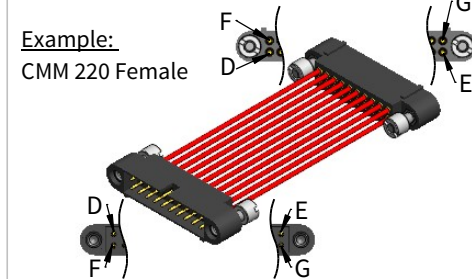
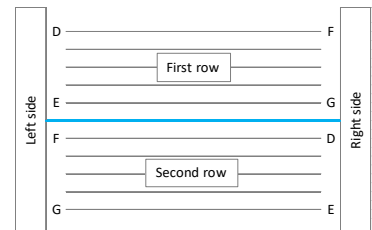

Technical features for harness components

Connector : The CMM micro-connectors are designed to meet or exceed the relevant electrical and environmental performances described in MIL-DTL-55302F & BS-9525-F0033 standards.

Backpotting : Dielectric grade epoxy encapsulant
Operating temperature : -40 to 130°C

Wire : All the AWG except AWG22 are compliant to MIL22759/11 :
- Conductor : Silver coated copper
- Insulation : Extruded PTFE
- Jacket : none
- Temperature rating : 200°C
- Voltage rating : 600V

AWG22 is compliant to MIL22759/18 :
- Conductor : Tin coated copper
- Insulation : Extruded ETFE
- Jacket : none
- Temperature rating : 150°C
- Voltage rating 600V

Coaxial cable : All the RG are compliant to MIL-C-17.



| | | | | |
|--------------------|----------|-------|---------|----------|
| 1 | 23/02/21 | P.B. | J.D. | C.F. |
| Iss | Date | Drawn | Checked | Approved |
| Item : CMM Harness | | | | |

This document is the property of Nicomatic. It may not be reproduced without the prior written permission of the owner. Law of 11 March 1902.

Catalogue Reference : HCxxGW(#)Pnn(n)F-yyzz-A#BDLLLL

Compliant matrix : -
Customer reference : -



General tolerance ±0.2
Page 2/2

D

A4